

## Enhanced return and sorting experience

With multiple entry points (up to 3), unlimited destination bin options, staff return stations, modular conveyance and bin sorting options, and a maximum sort speed up to 1,800 items/hour, our AMH 300 series provides an excellent balance between cost and functionality, delivering the ultimate in return and sorting capabilities required by leading libraries.

### Key Features

- Flexible solution, designed around your library
- Customer-facing touch-screen return point
- Internal and external entry point options
- RFID and barcode compatibility
- EM activation module option
- Accepts returns for all library media (books, media, etc.)
- Maximum sort speed up to 1,800 items/hour
- Integrated thermal printer for receipt confirmation
- Unlimited sorting / return bin options
- Easy maintenance access
- Emergency stop button



## External/internal frontend

Our internal and external entry points are the patron-facing interface for library customers, allowing them to return a range of items and access essential account information.

### Key Features

- Internal and external (weather-proof) options
- Mechanically operated, locking door
- Receipt printer
- Barcode login
- Basic account management on-screen
- Operates 24/7



## Staff return point / internal

For items that may have been returned within the main library or perhaps received in bulk from another branch, we provide the staff return point, which allows books and AV material to be placed directly onto the sorter.

### Key Features

- Quick and easy return point for staff
- No software interaction required
- Items sorted automatically
- ILS/LMS check-in and security re-added
- Keeps induction points free for customer use
- Emergency sorter stop button





The true flexibility of our AMH 300 series is the ability for the overall solution to be designed using proven components, with each sorter section assembled using a combination of movement options (both linear and 90 degree) and 2/3/4 or 5-way sorting modules. Using these components, our in-house AMH team work closely with the library installation team to ensure the perfect solution is designed, specified and installed.

## Sample configurations: 3 to 17 bins with one patron induction point

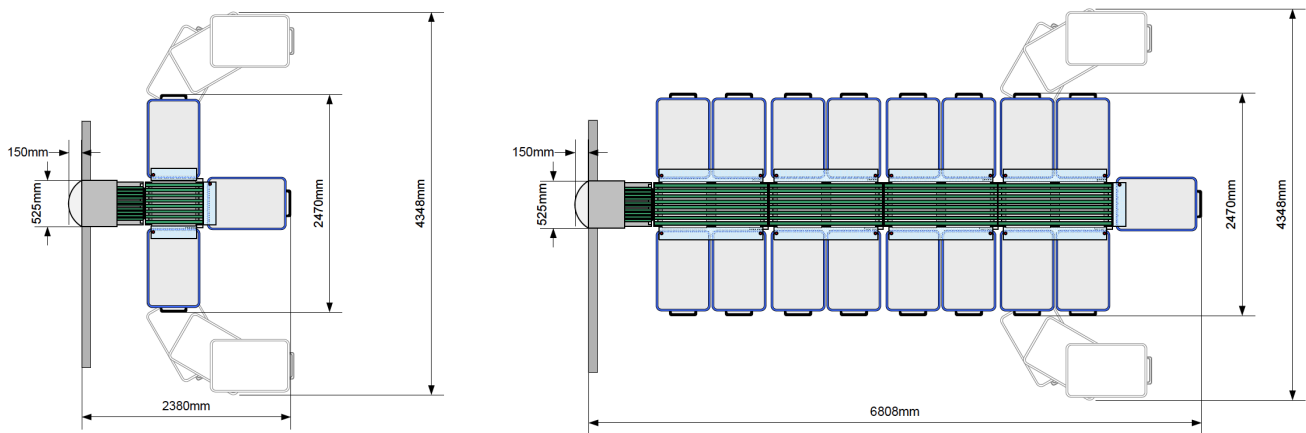

## Sample configurations: 3 to 17 bins with 2 patron induction points and a staff return

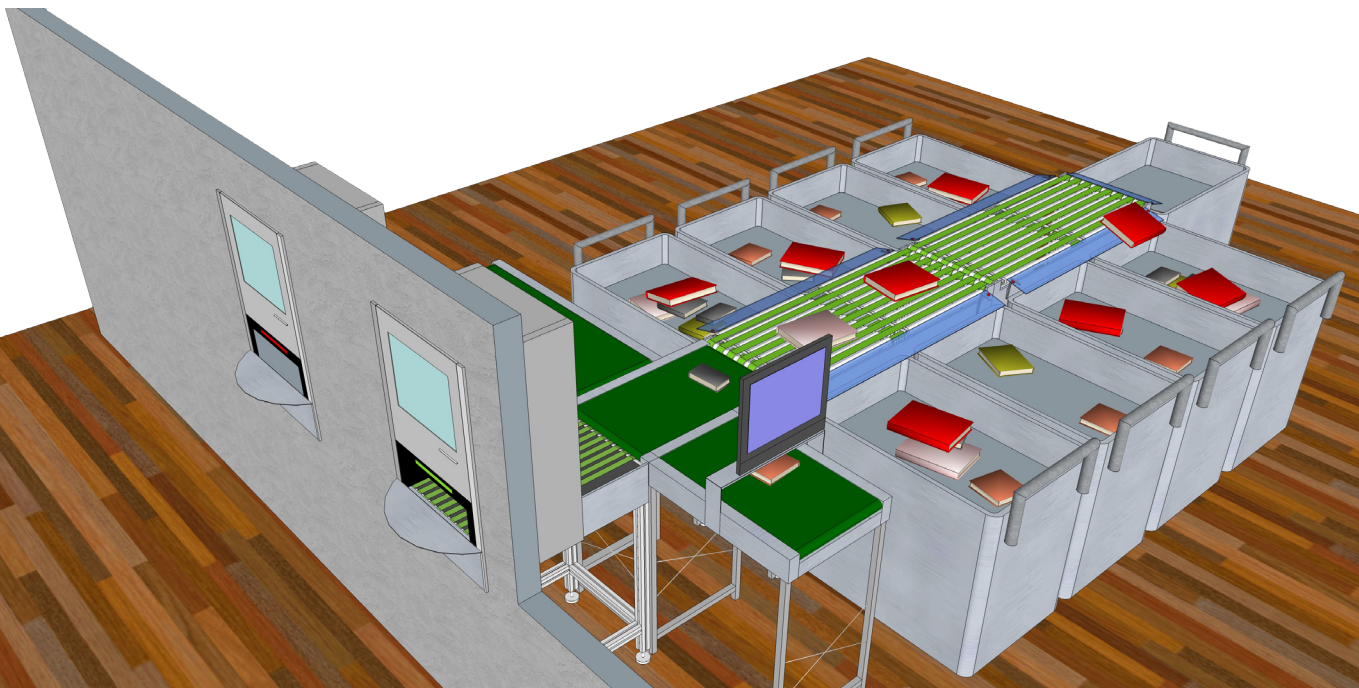
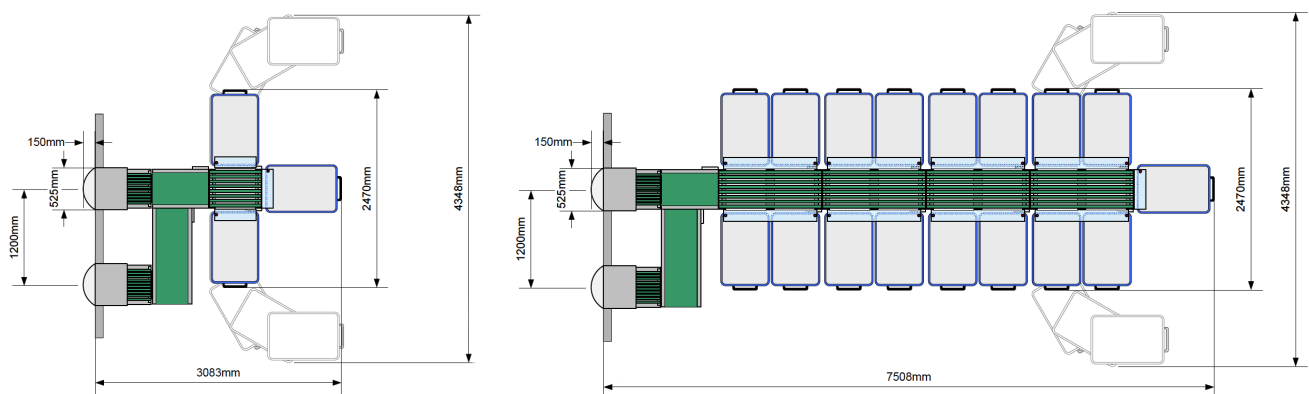

## Specifications

<b>Dimensions:</b>	<b>smartreturn™ frontend</b> : h: 687mm / 25.87" w: 535mm / 21.06"
	<b>Input level</b> : h: 950 mm / 37.40"
	<b>Large bin</b> : d: 900mm / 35.43" w: 600mm / 23.62"
	<b>Small bin</b> : d: 700mm / 27.56" w: 600mm / 23.62"
<b>Weight:</b>	<b>smartreturn™ frontend</b> : 130 kg / 286 lbs
	<b>smartsort™ 300 unit</b> : 70kg / 154.3lbs
<b>Power / connectivity:</b>	<b>smartreturn™ frontend</b> Main cabinet 110V – 240 V, 50/60 Hz Standby 185 W / consumption max. 480 W Depends on system size and configuration.
	<b>smartsort™ 300 unit</b> Standby 75 W Consumption SHORT module max. 230 W Consumption LONG module max. 260 W
<b>Item performance:</b>	<b>smartreturn™ frontend</b> : 900 items/h (max)
	<b>smartsort™ 300 unit</b> : 1,800 items/h
<b>Display:</b>	17" Display with LED- Backlight, luminosity 300cd/m², resolution 1280x1024 (S-XGA). Optional outdoor display: 700cd/m².
<b>Environmental facts:</b>	Working temperature (indoor): +5°C - +40°C / 41 F – 104 F Working temperature (outdoor): -15°C - +55°C / 5 F – 131 F Humidity: max. 80%
<b>Logical system configuration:</b>	Every module has a box for the power connection and the control unit.
<b>Standards / certification</b>	IP54
<b>Reporting:</b>	Configuration and reporting is immediately made available via our optional smartadmin™ central management software.
<b>Software:</b>	smartreturn™ software is delivered pre-installed and pre-configured with the AMH 300 series.
<b>Options:</b>	Additional sorting modules can be added in the future. External weather proofing (rain/bright conditions) Large or small size bins